



# Total Building Envelope Protection System



Substrate Penetration Protection



Window and Door Installation Sealants



Spray Applied Air & Moisture Barriers



Roller Applied Protective Membranes

***One System***

***One Technology***

***One Family of Products***

***That's The Power Of One***



**BEP Blue Barrier - The Single Source for Building Envelope Protection**

To Learn More About BEP Blue Barrier Products  
Visit [www. BEPproducts.com](http://www.BEPproducts.com) or Call 813.279.1902

# Architects, Builders and Applicators

## Need a Complete Building Envelope Protection Solution ?

### *Why Risk - Incompatible Product Failures*

- Poor Project Work Quality
- Customer Dissatisfaction
- Your Company Reputation

... When you can provide Total Building Envelope Protection with **One** fully compatible air & moisture barrier system, based on **One** proven STPE technology in **One** easy to use single family of products...



A complete building envelope protection system, specially designed for:

- Window and Door Installations
- Sealing Around Substrate Penetrations
- Spray Applied Air & Moisture Barriers
- Roller Applied Protective Membranes

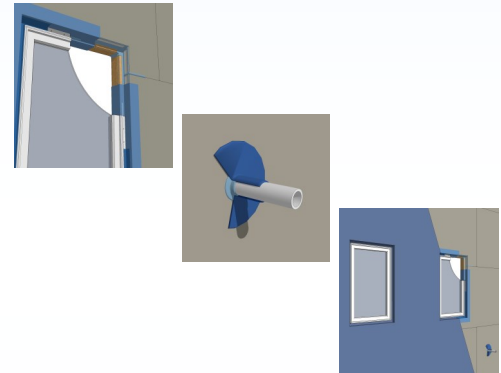

Liquid Flashing 2100

An all-purpose, liquid applied flashing used to bridge dissimilar construction materials and to create fully adhered pan membranes in window and door installations.



Joint Filler 2200

A structural adhesive and detail sealant used to fill voids and seams and to bond dissimilar construction materials.



Liquid Wrap 2300

A thin mil, spray applied, fully adhered, permeable air and moisture building envelope protection membrane used on vertical wall substrates.



Flash'N Wrap RG 2400

A roller applied liquid membrane for flashing applications bridging dissimilar materials, creating seamless pan membranes in window & door installations and for vertical wall substrate air and moisture protection coatings.

## *The Power Of One*

 **BEP Blue Barrier - The Single Source for Building Envelope Protection**